

# Gonorrhea/Chlamydia APTIMA® Swab Self Collection Instructions for Patients

## Kit Contents:



- Collection Swab (pink shaft)
- Specimen Transport Tube

**Note:** Patients obtain collection kits from their provider  
Collection **MUST** take place in the provider's office  
(This is not meant for at-home collection)

## Specimen Collection:

- Wash your hands before starting

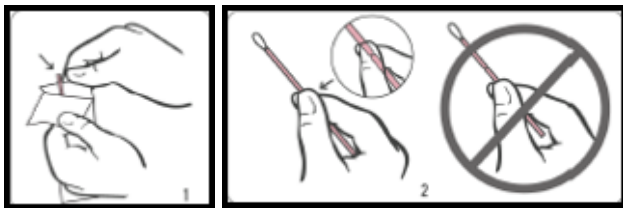

- Open the kit package and remove its contents
  - Do not touch the soft tip or lay the swab down
  - Do not touch the foil on the top of the specimen transport tube
- Hold the swab between your thumb and forefinger at the black score mark

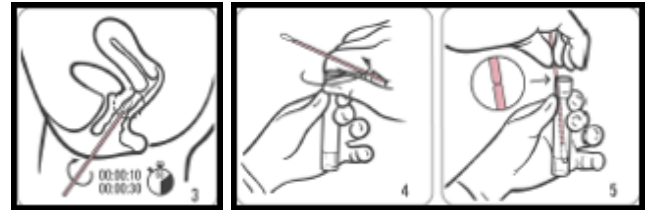

- Insert the swab into the opening of the vagina about 2 inches
  - Gently rotate the swab clockwise 10-30 seconds to ensure adequate sampling
  - Make sure the swab touches the walls of the vagina so that moisture is absorbed by the swab
  - Carefully remove the swab without touching the skin
- Place the swab into the specimen transport tube



- Break the swab shaft at the score mark
  - Be careful not to splash contents
  - Discard the remaining top portion of the swab shaft
- Tighten the cap
  - Be careful not to touch foil on top of cap
- Label transport tube with patient name and date of birth
- Transport sample to laboratory as soon as possible